

TABLEAU

BAR • BISTRO

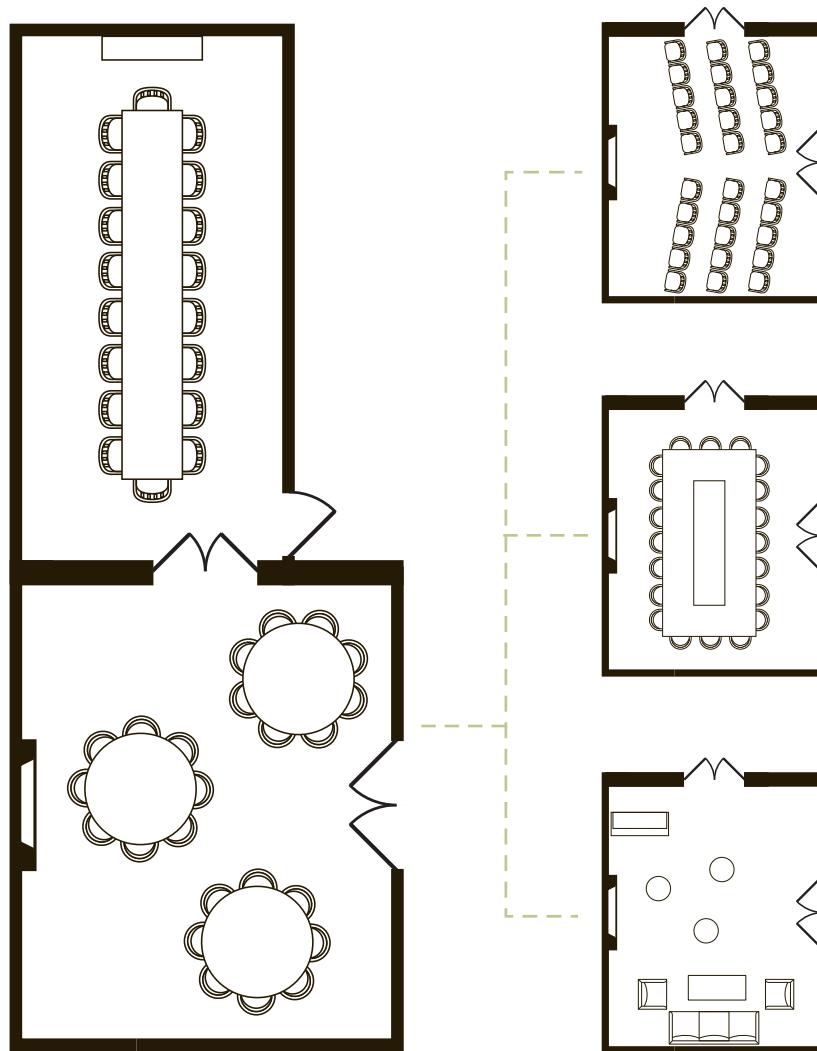

THE GRAND SALON

A jewel of a room, two striking doors lead to the Grand Salon. This 425 square foot space boasts a beautiful stainless steel chandelier, three wall mirrors, stainless steel fireplace and 12-foot coffered ceilings. A charming and unique venue, it is the ideal setting for meetings and gatherings from 8 to 40 people accommodating a variety of set-up styles. The Grand Salon's open space and high ceilings are versatile, lending sophistication to a Vancouver private party, corporate event, cocktail reception or sit down dinner. Technologically savvy the Grand Salon features a 100" drop down projection screen, two 55" flat screen televisions, state-of-the-art audiovisual and teleconferencing capabilities, notebook hook ups, blu-ray DVD, wireless internet and in-house technical support staff ensuring flawless presentations. Customized menus and special catering services are provided by Tableau Bar Bistro. If that is not enough, solid wood door leads to the Petit Salon allowing guests to step away from the meeting – making it perfect for working lunches, break out meetings or a pre-function cocktail reception. By any standard, its beauty, meeting functionality and technological advancements makes the Grand Salon the ideal Vancouver event location. Dimensions 23' x 18.5'. Square Feet 425 sq ft. Capacities 24 seated; 40 reception style.

TABLEAU

BAR • BISTRO

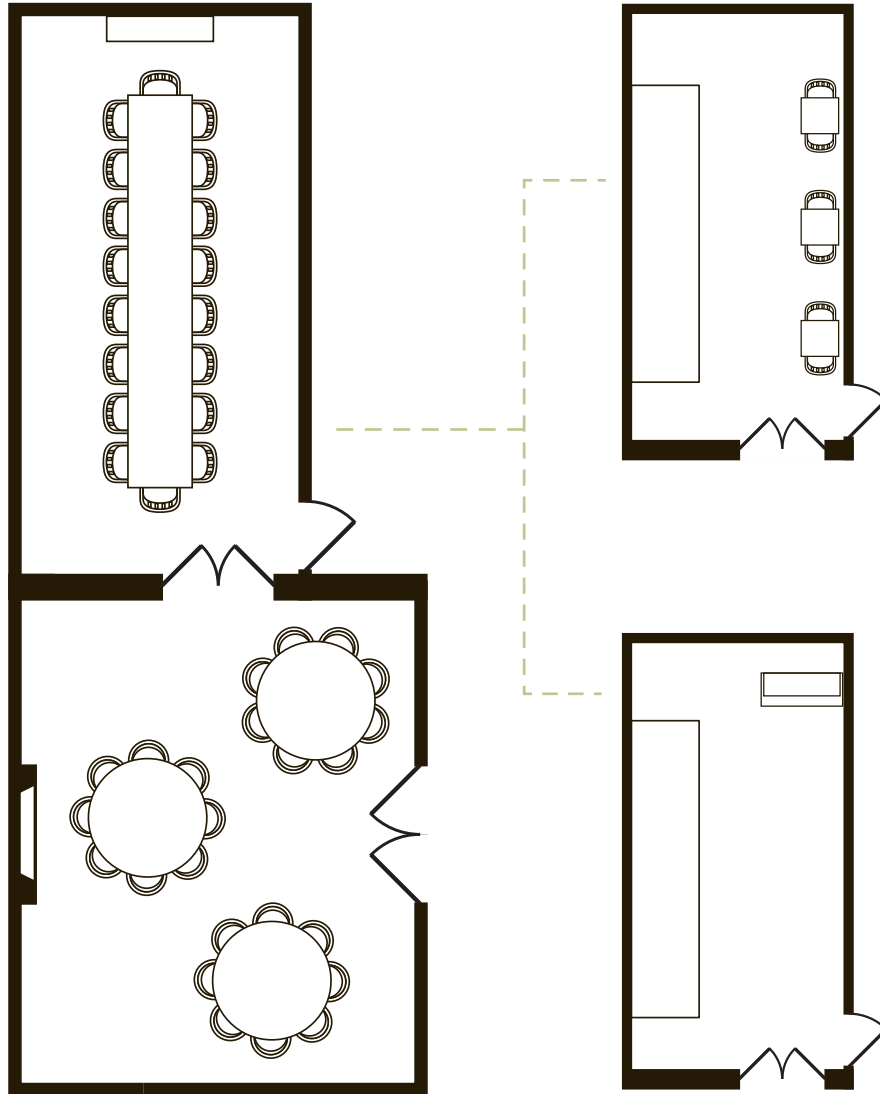

THE PETIT SALON

This intimate 290 square foot private dining room seats up to 18 guests for a sit-down or a rehearsal dinner. Adorned in a palette of warm tones including chocolate brown, amber, matte black, soft gold and low sheen metals play off each other to create mood and drama – giving this room an impressive look and ideal setting for intimate gatherings. Well equipped with state-of-the-art audiovisual and teleconferencing capabilities including a 48" flat screen television, blu-ray DVD, notebook hook ups, wireless internet and in-house technical support staff. The Petit Salon is a stunning private event venue for sophisticated gatherings. Dimensions 11.5' x 26'. Square Feet 290. Capacities 18 sit down; 30 reception style.